

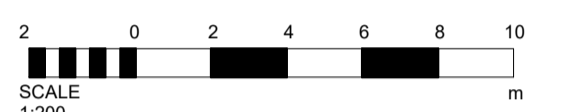

Notes:
 - Do not scale from this drawing. Use figured dimensions in all cases.
 - Verify dimensions on site and report any discrepancies to the Architect immediately.
 - This drawing is to be read in conjunction with the Architect's Specification.
 - © This drawing is copyright and may only be reproduced with the Architect's permission.

Drawing Notes:

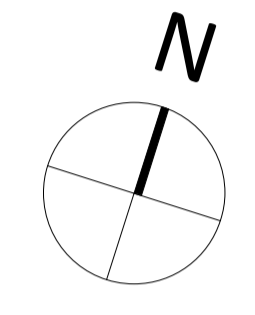
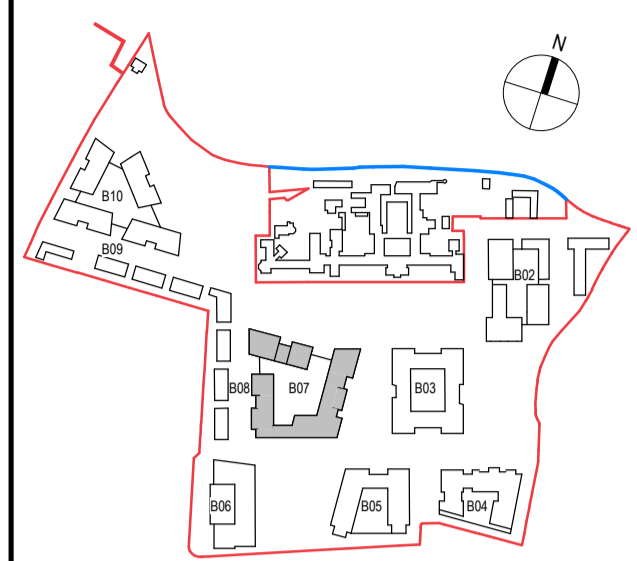

Planning Legend

- Site Boundary
- Residential Entrance
- Service Entrance
- 1B2P Studio Apartment
- 2B3P 1 Bed Apartment
- 2B4P 2 Bed Apartment (4 Person)
- 3B5P 3 Bed Apartment
- Parking
- Retail

Rev.	Date	Drawn	Details of Issue / Revision
P03.08	23/03/22	MMG	SHD Planning Application

Issues & Revisions

reddy architecture + urbanism

Dartry Mills,
Dartry Road
Dublin 6,
D06 Y0E3

T: +353 (0)1 498 7000
W: www.reddyarchitecture.com
E: info@reddyarchitecture.com

Client Details:
Land Development Agency

Project Details:
**Dundrum Central Development
 Dundrum Road
 Dublin 14**

Drawing Title:
Block 07, Ground Floor, GA Plan

Job No. P19-233D	Sheet Size A1_Landscape	Scale @A1: 1 : 200
Issue Date: 23/03/22	Drawn By: M. McGuire	Reviewed By: L. Wynne

Status S3	Purpose of Issue SHD Planning Application
Project-Originator-Zone-Level-Type-Role-Classification-Number DCD-RAU-02-B07_00-DR-A-1700	Revision P03.08